

NOWSIGNAGE 

SECTORS //

# Corporate

Retail

Education

Industrial

Hospitality

Stadia & Events

Healthcare

Places of Worship

Transport

Fitness

Franchises

DOOH



# Digital Signage for Corporate

Companies that communicate effectively are four times more likely to report higher levels of employee engagement. Disengaged employees are twelve times more likely to leave their job within the current year. These are just a few facts that demonstrate the value and importance of implementing effective digital signage across your office space or work environment. NowSignage provides a simple and cost effective way to get important information to the right people at the right time. The CMS is designed for multi-screen management, therefore, managing a large network of hundreds of screens is no more difficult than managing a handful of screens.



## Internal Communication

Use our multi zone layouts to display important internal comms and live data feeds through IPTV, RSS feeds, weather and traffic. NowSignage also has integrations with many third party applications such as Microsoft & Google (Sheets, Maps and Power BI) making communication with key stakeholders via digital signage easier than ever before.



## Signage in Receptions

Keep staff and visitors well informed in your public areas and receptions with a variety of dynamic content such as, IPTV streams, social media feeds, local weather, local traffic. With NowSignage, it's easy to create a truly eye-catching digital signage experience to help continually engage your audience and ensure they don't "switch off" from your screens, video walls or even digital hand sanitisers.

**WINNER**

AV AWARDS  
2020  
20TH NOVEMBER LONDON

NOWSIGNAGE

## Share Social Media

To keep your audience engaged and prevent them from tuning-out, it is essential that you keep your content targeted and relevant to them. By creating automated RSS feeds and social media walls, your teams can be kept abreast of internal and external news that's specific and relevant to them, ensuring your people stay informed and remain engaged.

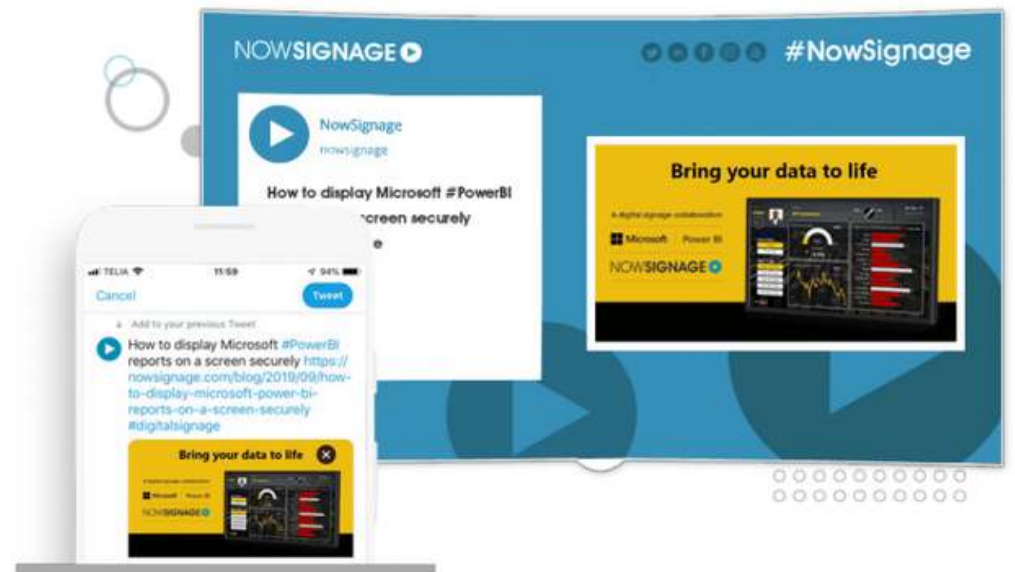

## Activate Microsoft Power BI

NowSignage is the only CMS to have developed a full integration with Microsoft Azure, so that Power BI users can display BI reports, dashboards, and other data, completely privately and securely. Within a corporate environment, it is imperative to cut through the noise and succinctly present business critical information to a relevant audience at a time and place that allows them to make informed decisions.

## Real-Time Announcements

Keep staff informed around updated social distancing rules or even warn staff about potential disruptions to the working day such as fire alarm tests by using our real-time announcements feature. You could even use this feature to ensure your staff stay motivated and engaged, by using it to celebrate employee birthdays or wish them a happy work anniversary!

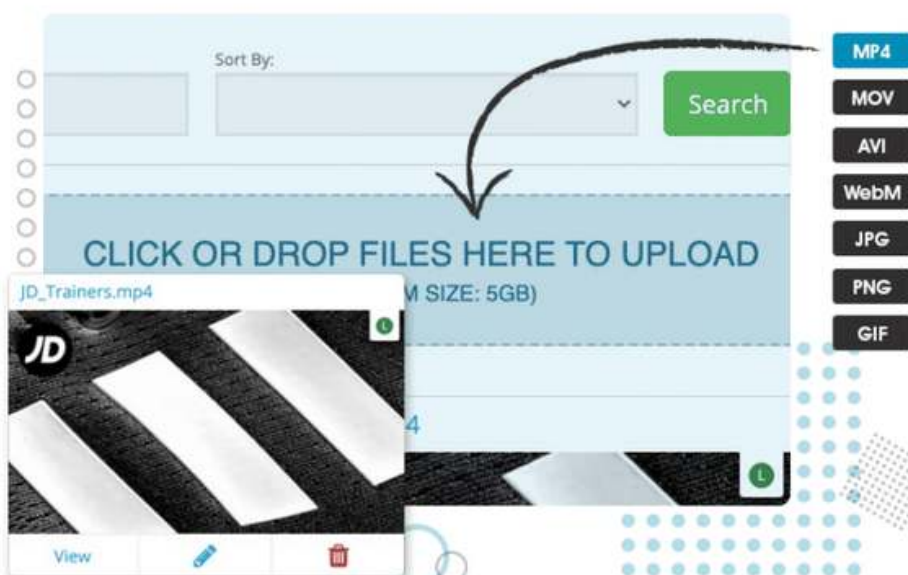

## A Marketeers Dream

NowSignage is what you might call a self-serve platform, so easy and reliable to use, that you shouldn't need much support from us! However, NowSignage always ensures that the very best support is available by providing access to a plethora of video guides, and even a direct Account Manager should you need to speak to us in person!

**WINNER**

AV AWARDS  
2020  
20TH NOVEMBER LONDON

NOWSIGNAGE

# Our features provide users with the ultimate out-of-the-box digital signage solution

Unlike other providers on the market, NowSignage provides the very best features to all users at no extra cost. We take feedback from our users every single month on what features they would like to see in our platform and, as such, we are rolling out new features all the time, but your price will remain the same! So, whether you are using our world-first Microsoft Power BI integration, our best-in-class social media feeds or our IPTV features we will never charge you any more than your standard license fee.

**01 // Image & Video**

**02 // Social Media**

**03 // RSS News**

**04 // IPTV**

**05 // Multi-Zone**

**06 // Scheduling**

**07 // YouTube**

**08 // Webpages**

**09 // Announcements**

**10 // Google Traffic**

**11 // Microsoft Power BI**

**12 // Roles & Permissions**

**13 // Hardware Management**

**14 // Proof of Play**

**15 // Video Wall**

**16 // Screen Synchronisation**

**17 // Capacity Management**

**18 // Dispenser Management**

**19 // Weather**

**20 // Google Suite**



***"The most advanced, secure & cost effective CMS on the market"***

**James Mellor of Coca-Cola Enterprises**



**WINNER**

**AV AWARDS**  
**2020**  
20TH NOVEMBER LONDON

**NOWSIGNAGE**

## 1. Most affordable

True SaaS, all users, are granted access to the exact same features and functionality at no extra cost. Our aim is to develop and maintain the best CMS on the market.



### 3. Easy to use

Possibly the easiest to use CMS anywhere in the world today, which means that any end-user can be fully trained and competent on NowSignage within just 30 minutes.

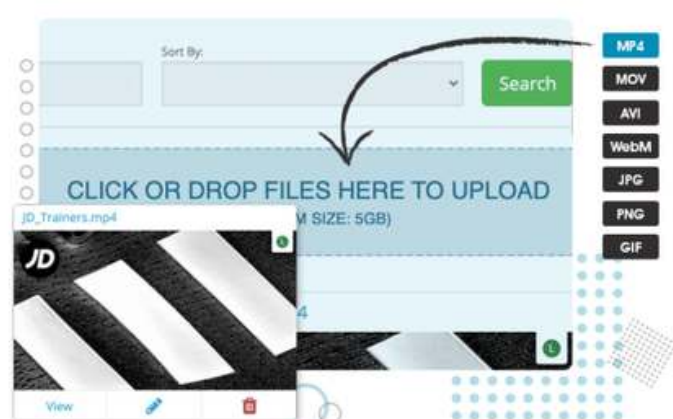

## 5. Custom integrations

Industry leaders in achieving award-winning direct integrations with 3rd party softwares. When we develop an integration, we do it properly with a full API integration.

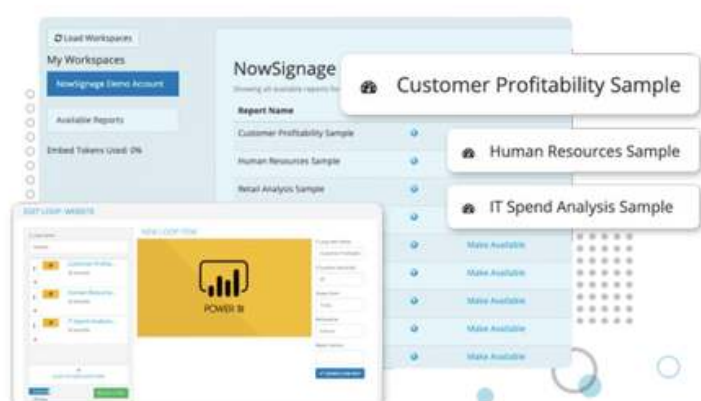

## 2. Secure & reliable

We pride ourselves on maintaining the correct and latest security processes across all aspects of our platform, holding security and compliance in the highest regard.



#### 4. Hardware agnostic

Hardware-agnostic through a single codebase, you can therefore rest assured that whatever hardware, media player or SoC, NowSignage will just work.



## 6. Superior support

Uncompromising when it comes to support, we provide unlimited access to pre & post sales support, plus free automatic upgrades as we release improvements.



## Our Corporate Customers

NowSignage is trusted and deployed extensively across the corporate sector. NowSignage has a total of 4,000+ registered users and is implemented across 30+ countries by many of the world's biggest brands. Our established partner ecosystem comprises of manufacturer and solution partners, ensuring that NowSignage can be implemented across any corporate location at ease.



*"Digital signage was the perfect tool to broadcast our live metrics and targets to our employees across the globe. NowSignage were the only offering we found that could provide a secure solution to PowerBI on digital signage, and we're delighted with the result."*

Sean Paul Bradley, Continuous Improvement Director at Robert Walters



**WINNER**

AV AWARDS  
2020  
20TH NOVEMBER LONDON

NOWSIGNAGE

# Our Microsoft Power BI Customers

NowSignage are the only digital signage platform on the market that have a full integration with Microsoft Power BI to enable users to display their reports privately and securely.



*"Digital signage was the perfect tool to broadcast our live metrics and targets to our employees across the globe. NowSignage were the only offering we found that could provide a secure solution to PowerBI on digital signage, and we're delighted with the result."*

Sean Paul Bradley, Continuous Improvement Director at Robert Walters

A digital signage collaboration

Microsoft | Power BI

NOWSIGNAGE



WINNER

AV AWARDS  
2020  
20TH NOVEMBER LONDON

NOWSIGNAGE

# Case Study: Live Power BI reports onto Global office screens

**End User:** Robert Walters

**Live Date:** July 2019

**Active screens:** 200+

**Location:** Global (31 countries)



Robert Walters are one of the world's leading specialist recruitment consultancy and outsourcing providers. They currently employ 4,300 staff operating across 31 countries.

As a rapidly growing global business, Robert Walters set about with an agenda to better improve employee engagement by making real time data visible and target driven. Digital screens located throughout the global offices were identified as a primary outlet to achieve this and as such the IT team at Robert Walters were immediately tasked with finding a way to securely display live business intelligence reports onto their 200+ screens.

Being an enterprise-level user of Microsoft Power BI, the ability to collate data from hundreds of data sources and then visualise them into business critical data reports and live dashboards, was not a concern for Robert Walters. The issue lay with being able to present these reports securely onto a screen without making them publicly available across the web.

Up stepped NowSignage, with the only solution on the market that enables Microsoft Power BI users to display their private reports onto screens through their digital signage network. By activating the Microsoft Power BI within the NowSignage in-platform app store, users can connect their Microsoft Power BI account directly to the NowSignage platform through a 'first of its kind' integration. Once connected the NowSignage user can select their private reports and broadcast them as stunningly animated visualisations which tell their data stories with real-time content on any targeted office screen.

Sean Paul Bradley, Continuous Improvement Director, Robert Walters, said: ***"Digital signage was the perfect tool to broadcast our live metrics and targets to our employees across the globe. NowSignage were the only offering we found that could provide a secure solution to PowerBI on digital signage, and we're delighted with the result."***

Until now, many digital signage providers have claimed to have integrations with Microsoft Power BI, however this has always been limited to displaying only publicly available links. When it comes to displaying private business intelligence or confidential financial data, it is incomprehensible for companies to knowingly generate these private reports as a public links.

**WINNER**

**AV AWARDS**  
**2020**  
20TH NOVEMBER LONDON

**NOWSIGNAGE**

Get in touch:

[sayhello@evoketech.co.uk](mailto:sayhello@evoketech.co.uk)

01482 460920

